

# TEMPTEK VACUUM LOADERS

- 5 to 19 lb.
- Remote Mount Mini PLC Control
- Modular Design
- 3 Models to choose from:
  - VL-5-T
  - VL-12-T
  - VL-19-T

**TempTek Series Vacuum Loaders** provide self-contained, vacuum transfer of plastic pellets and regrinds over short distances using powerful single-phase vacuum motors. Standard models are made for flange mounting to existing bins or hoppers. Machine Mount packages provide a quick disconnect glass tube base with integrated vacuum flapper. A proportioning valve option may be easily added to any model.

- Reinforced filter disc has polyester layer to trap fines and rigid metal backing to extend filter life.
- Compressed-air blowback reduces filter clogging for less maintenance.
- Includes 15 ft. (4.6m) length of flex hose, pickup wand and hose clamps.
- All material contact points are non-ferrous.
- Dump Valve with integrated demand level switch on standard models.
- One Year warranty (Excludes normal maintenance items.)

• **MADE IN THE USA!**

*Delivery by FedEx freight Included!*



**Micro PLC Based Control**

- Complete programming and monitoring capabilities
- Graphic faceplate displays parameter value codes and provides step-by-step programming instructions
- Can be remotely located at operator level

**In Stock!pm  
Quick Ship!**



VL-12-T

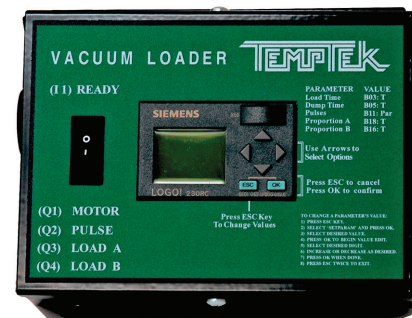

Micro PLC Control

**For More Information ... call SWHC 214-340-7500  
PRICE & PERFORMANCE... for the LONG TERM**

Distributed By:



SOUTHWEST  
HEATER & CONTROLS

10610 CONTROL PLACE  
DALLAS, TEXAS 75238

MAIN: 214-340-7500  
TOLL FREE: 800-687-2220

SALES@SWHC.COM  
**SWHC.COM**



since 1989

# SPECIFICATIONS

Model	VL-5-T	VL-12-T	VL-19-T
<b>VOLUME</b>	1/8 ft. <sup>3</sup>	1/3 ft. <sup>3</sup>	1/2 ft. <sup>3</sup>
<b>RESIN CAPACITY</b>	5 lb.	12 lb.	19 lb.
<b>DISChArg E DIAMETER</b>	2 in.	2 in.	2 in.
<b>MACHInE MOUNT DISChArg E DIAMETER</b>	1.5 in.	1.5 in.	2 in.
<b>**RECOMMENDED (MAX) ThROUgh PUT/h.R.</b>	200 (350)	400 (600)	500 (700)
<b>†MAXIMUM CONVEYIng DISTANCE</b>	50 ft.	50 ft.	50 ft.
<b>LOAD TIME: (SECONDS)</b>	up to 99	up to 99	up to 99
<b>DUMP TIME: (SECONDS)</b>	up to 99	up to 99	up to 99
<b>AMPS @115V</b>	8	13	13
<b>COMPRESSED AIR USAg E</b>	.2 CFM		
<b>DIMENSION A</b>	23"	28"	32"
<b>DIMENSION B</b>	17"	22"	26"
<b>DIMENSION C</b>	5"	11"	15"
<b>DIMENSION D</b>	6"	10"	10"

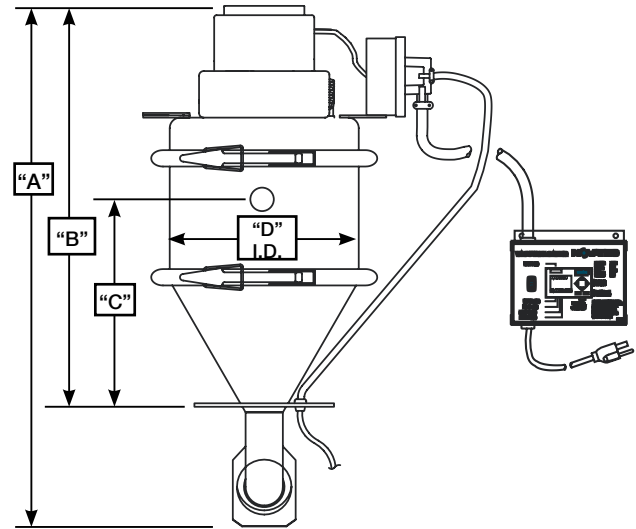

Mounting Pattern

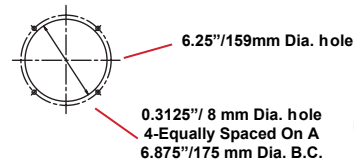

VL-5-MM-T

### Machine Mount Model Dimensions:

All models with standard 2 lb. capacity glass: Add 3" to Dimension A above.

\* Resin capacity and throughput based on 38 lb./ft<sup>3</sup> bulk density. Adding external proportioning valve reduces throughput.

\*\* Max rate based on use with 10'(ft) flex hose. Recommended average rates produce optimal use and life expectancy, exceeding the maximum recommended rates will shorten motor and brush life.

† Horizontal distance based on transporting virgin resin through tubing. Vertical travel, bends and flex hose will reduce conveying distance.

**NOTE:** Maximum rate based on virgin pellets from close distance. Recommend brushes be changed every 300 hour of operation.



### Proportioning Option:

EPV-15T-12-T Includes wand and 10' flex hose

Machine Mount Adapter  
(Included with MM mode[s])

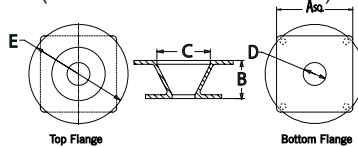

Machine Mount Adapter Dimensions						
Model	g lass Size lb./kg	A	B	C	D	E
VL-5-MM-T	2/.9	5	2.5	3.5	1.5	6.5
VL-12-MM-T	2/.9	5	2.5	3.5	1.5	6.5
VL-19-MM-T	8/3.6	6.5	2.5	3.5	2.25	6.5

## GENERAL SPECIFICATIONS - ALL MODELS

- INLET DIAMETER:** 1.5" O.D.
- SUPPLY VOLTAg E:** 115/1/50-60
- PULSE DURATION:** 500 milliseconds
- TOTAL PULSES:** 1-999 (Adjustable, dump time dependent)
- AIR SERVICE:** 80 PSI required



For More Information ... call SWHC 214-340-7500

PRICE & PERFORMANCE... for the LONG TERM

Distributed By:



SOUTHWEST  
HEATER & CONTROLS

10610 CONTROL PLACE  
DALLAS, TEXAS 75238

MAIN: 214-340-7500  
TOLL FREE: 800-687-2220

SALES@SWHC.COM  
SWHC.COM



since 1989